

Overview



SITRANS WF200 and WF250 flowmeters are medium to high capacity flowmeters for various product sizes, densities, and fluidities.

Benefits

- For specialized pre-feed applications
- Sensing element mounted outside process
- Flowrates from 200 to 900 t/h (220 to 990 STPH)
- Continuously monitoring of the material flow without interrupting the process
- Dust-tight construction: suitable for use in hazardous areas and in washdown applications that require frequent cleaning
- Minimal maintenance or recalibration after the initial installation and material tests

Application

Operating with a microprocessor based integrator package, the WF200 series flowmeters display flow rate, totalized flow, and rate alarms. Outputs are 0/4 to 20 mA proportional to rate and contact closure for remote totalization. Dry bulk solids enter the flowmeter before continuing through the process unhindered. The load cells convert the horizontal force of the deflection into an electrical signal. The integrator processes this into flowrate and integrated total weight. The sensing process is immune to the effect of product build-up as only the horizontal force is measured.

With load cells located externally to the process, the WF200 series flowmeters measure high capacities with a maximum rate of 900 t/h (990 STPH). For high capacity aerated gravity conveyor pre-feed, the WF250 has a maximum rate of 900 t/h (990 STPH).

- Key applications: aggregates, grain, cement, mineral processing

SITRANS WF200 series

Selection and ordering data

| SITRANS WF200 series Solids flowmeters Impact solids flowmeter for medium to high capacity applications. Accuracy is $\pm 1\%$ or better, with capacity up to 900 t/h (990 STPH). | | Article No. | | | |
|--|--|-------------|---|---|--------------|
| | | 7 | M | H | 7115-●●●●●-0 |
| Click on the Article No. for the online configuration in the PIA Life Cycle Portal. | | | | | |
| Model | | | | | |
| <u>SITRANS WF200</u> | | | | | |
| 500 t/h maximum design capacity | | | | 1 | |
| 900 t/h maximum design capacity | | | | 2 | |
| <u>SITRANS WF250, aerated style</u> | | | | | |
| 500 t/h maximum design capacity | | | | 3 | |
| 900 t/h maximum design capacity | | | | 4 | |
| Construction | | | | | |
| Painted mild steel with 304 stainless steel sensing plate | | | | A | |
| Sensing plate liner | | | | | |
| None | | | | | A |
| <u>Polyurethane</u> | | | | | |
| For model options 1 and 3 | | | | | B |
| For model options 2 and 4 | | | | | C |
| <u>Alumina ceramic tiles</u> | | | | | |
| For model options 1 and 3 | | | | | D |
| For model options 2 and 4 | | | | | E |
| Load cell | | | | | |
| 50 lb | | | | | 1 |
| 100 lb | | | | | 2 |
| Not specified (for quotation purposes only, not a valid ordering option) | | | | | 0 |
| Approvals | | | | | |
| Ordinary Locations/General Purpose (Non-Ex), CE, UKCA, RCM, EAC | | | | | 1 |
| CSA/IM Class II, Div. 1, Groups E, F, G; Class III; ATEX II 2D Ex tb IIIC T80 °C Db IP65, Ta = -40 °C to +65 °C; UKEX II 2D Ex tb IIIC T80 °C Db IP65, Ta = -40 °C to +65 °C; IECEX Ex tb IIIC T80 °C Db IP65, Ta = -40 °C to +65 °C; EAC Ex, 0Ex tb IIIC T80 °C Db X; CE, UKCA, RCM | | | | | 2 |

1) Not available with construction option A.

| Further designs | Order Code |
|--|------------|
| Please add "-Z" to article no. and specify order code(s). | |
| Stainless steel tag [69 x 38 mm (2.7 x 1.5 inch)], Measuring-point number/identification (max 27 characters), specify in plain text. | Y15 |
| Application Eng. reference number (max.15 characters), specify in plain text. | Y31 |
| Manufacturer's test certificate: According to EN 10204-2.2 | C11 |
| Inspection certificate type 3.1 per EN 10204 ¹⁾ | C12 |
| Instruction manuals | |
| All literature is available to download for free, in a range of languages, at http://www.siemens.com/weighing/documentation | |

| Spare parts | Article No. |
|--|-------------|
| Calibration hanger weights | |
| Note: calibration accessories should be ordered as a separate item on the order. | |
| 20 g (0.04 lb) | 7MH7724-1AC |

| Spare parts | Article No. |
|---|--------------|
| 50 g (0.1 lb) | 7MH7724-1AD |
| 100 g (0.2 lb) | 7MH7724-1AE |
| 200 g (0.4 lb) | 7MH7724-1AF |
| 500 g (1.1 lb) | 7MH7724-1AG |
| 1 000 g (2.2 lb) | 7MH7724-1AH |
| 2 000 g (4.4 lb) | 7MH7724-1AJ |
| 5 000 g (11 lb) | 7MH7724-1AK |
| Load cell, 50 lb, stainless steel | PBD-23900246 |
| Load cell, 100 lb, stainless steel | PBD-23900247 |
| WF calibration pulley with hardware and cable spare | 7MH7723-1LT |
| WF200 series bearing with plate mount shaft, standard, spare | 7MH7723-1LU |
| WF200 series bearing with plate mount shaft, stainless steel, spare | 7MH7723-1LV |
| WF200 series sensing plate support cables, spare | 7MH7723-1LW |
| WF250 series sensing plate support cables, spare | 7MH7723-1LX |
| WF200 sensing plate 500 TPH 304, standard | 7MH7723-1LY |
| WF200 sensing plate 900 TPH 304, standard | 7MH7723-1MA |
| WF250 sensing plate 500 TPH 304, standard | 7MH7723-1MB |
| WF250 sensing plate 900 TPH 304, standard | 7MH7723-1MC |

Selection and ordering data (continued)

| Spare parts | Article No. |
|---|-------------|
| WF200 sensing plate 500 TPH 304, polyurethane lined | 7MH7723-1MD |
| WF200 sensing plate 900 TPH 304, polyurethane lined | 7MH7723-1ME |
| WF250 sensing plate 500 TPH 304, polyurethane lined | 7MH7723-1MF |

| Spare parts | Article No. |
|---|-------------|
| WF250 sensing plate 900 TPH 304, polyurethane lined | 7MH7723-1MG |
| WF200 sensing plate 500 TPH 304, ceramic lined | 7MH7723-1MH |
| WF200 sensing plate 900 TPH 304, ceramic lined | 7MH7723-1MJ |
| WF250 sensing plate 500 TPH 304, ceramic lined | 7MH7723-1MK |
| WF250 sensing plate 900 TPH 304, ceramic lined | 7MH7723-1ML |

Dimensional drawings

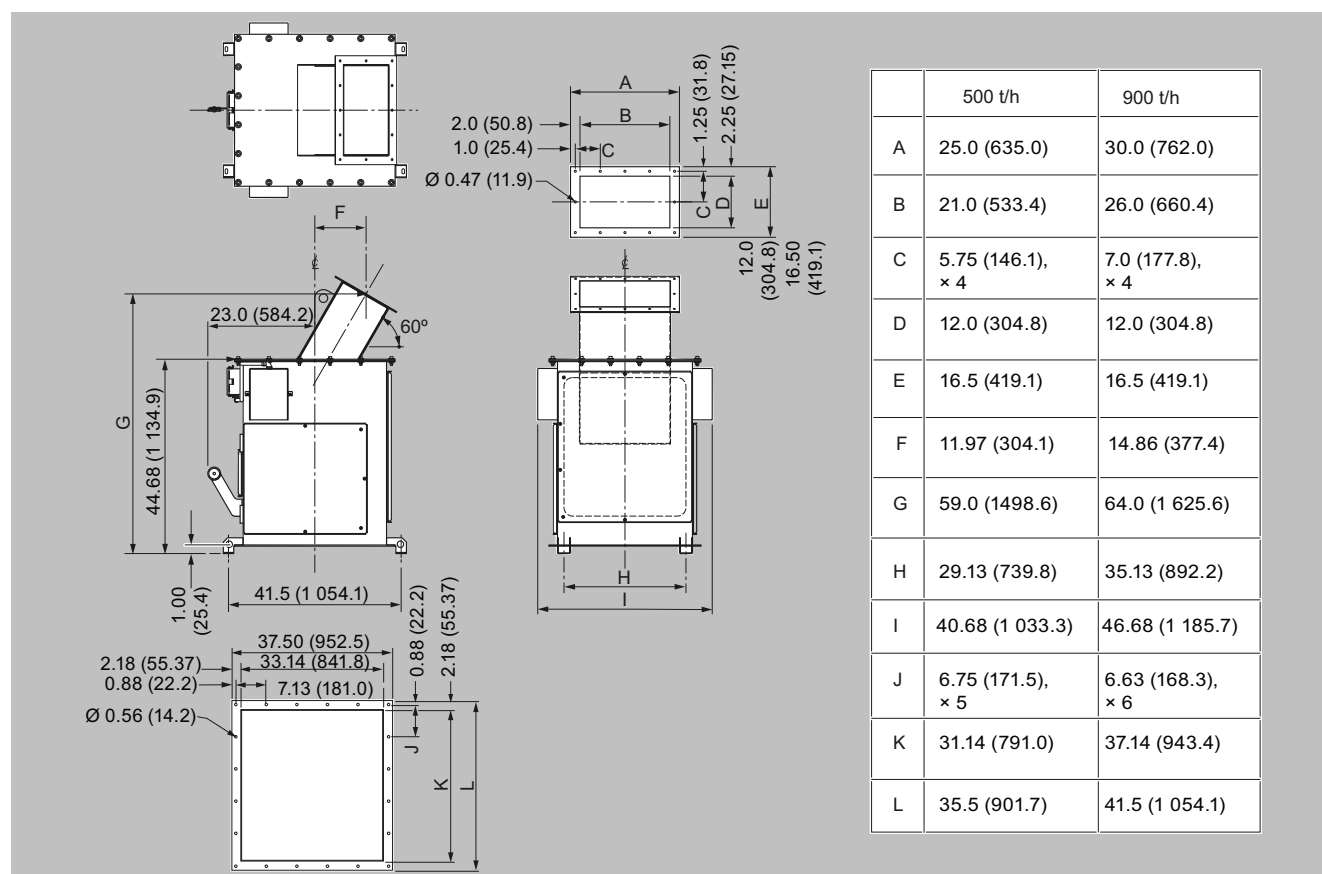

SITRANS WF200, dimensions in inch (mm)

SITRANS WF200 series

Dimensional drawings (continued)

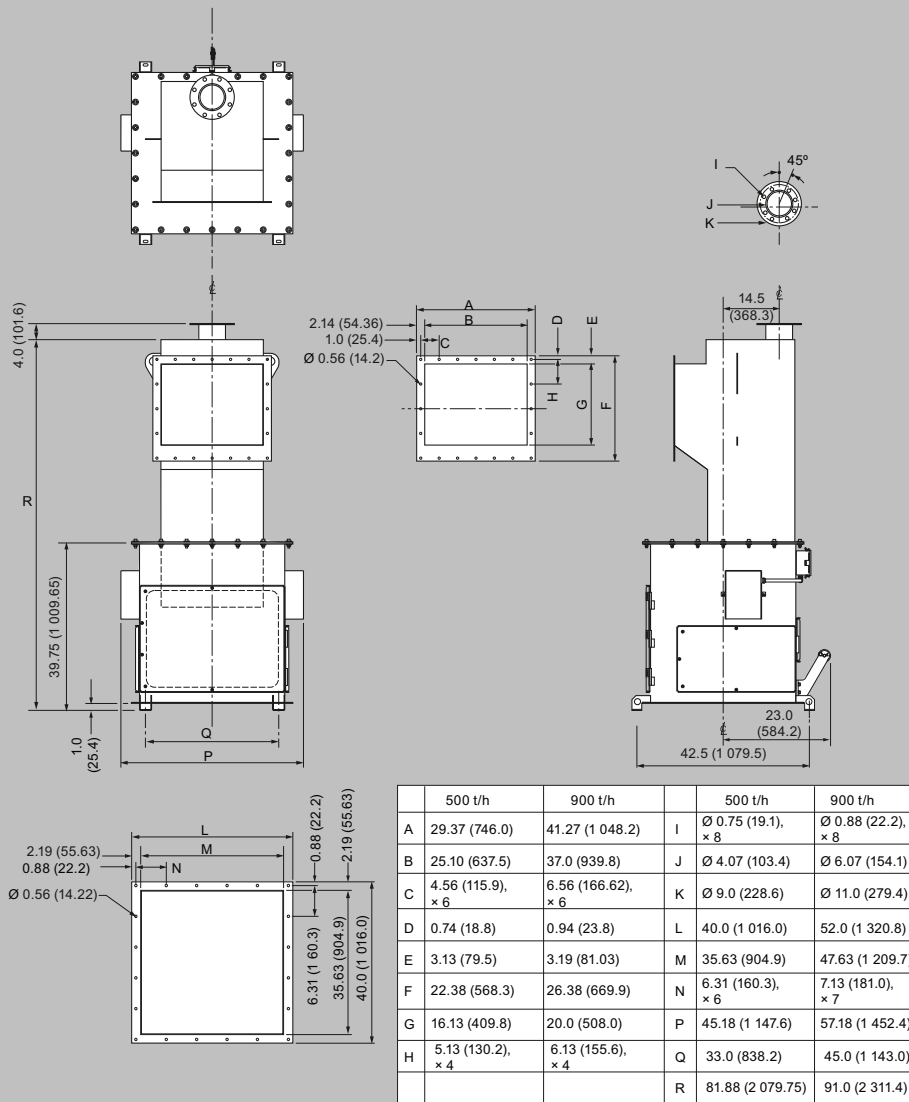

SITRANS WF250, dimensions in inch (mm)

Circuit diagrams

Note: conduit and cable arrangement may differ from example shown.
Conduit and connector not provided on hazardous option

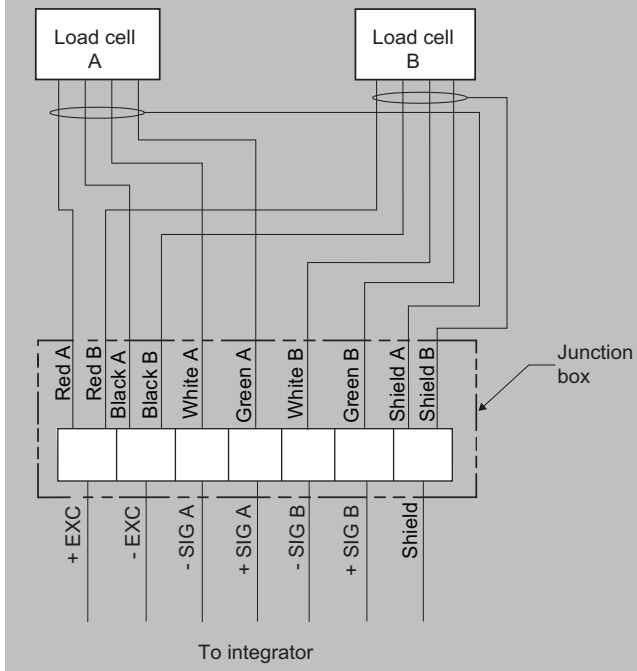

SITRANS WF200 series connections